



F Series - F1

Electric Pallet Truck 1.5T

- A durable truck for industrial applications
- Platform-based design to maximise competitive advantage in the market
- Cost-saving operations throughout the distribution cycle

EP EQUIPMENT CO.,LTD
www.ep-equipment.com



F1 – A durable truck for industrial applications

F Series shares the same highly- integrated tiller design which offers easy management and efficient maintenance for daily usage. It also makes cost-effective distribution process possible by 3 units per box as standard.

F1 inherits the practical features of EPT20-15ET: integrated charger and 24V/65Ah AGM battery for industrial needs and market-proven drive unit for endurance and stability.

F1 is an optimized solution for those who undertake heavy-duties in rugged scenarios.



Why F Series ?

■ Platform-based design to maximise competitive advantage in the market

F series features the platform F, which simplifies the configuration of the truck and allows buyers to choose from 4 different chassis by application. The product design provides value and creates a flexible product strategy by introducing new equipment that meets various market requirements.

■ Cost-saving operations throughout the distribution cycle

3 units per box as standard wholesale supply reduces overall spending through the entire distribution process. F1 accommodates **132 units** in a 40' shipping container compared to 64 units of EPT20-15ET, that can reach as high as **50%** of ocean freight charges reduction.

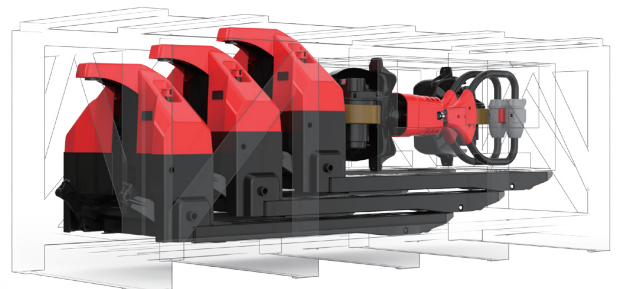

Electric Pallet Truck 1.5T

F1

Distinguishing mark	1.1	Manufacturer			EP
	1.2	Model designation			F1
	1.3	Drive			Electric
	1.4	Operator type			Pedestrian
	1.5	Load capacity	Q	kg	1500
	1.6	Load center distance	c	mm	600
	1.8	Load distance, centre of drive axle to fork	x	mm	883/946
	1.9	Wheelbase	y	mm	1157/1220
	Service weight	2.1	Service weight		kg
2.2		Axle loading, laden front/rear		kg	540/1105
2.3		Axle loading, unladen front/rear		kg	115/30
Tyres/chassis	3.1	Tyre type			Polyurethane
	3.2.1	Tyre size, front		mm	210x70
	3.3.1	Tyre size, rear		mm	Φ80x60(Φ74x88)
	3.4	Additional wheels (castor wheels)		mm	Φ74x30(Optional)
	3.5	Wheels, number front/rear (x=drive wheels)		mm	1x 2/4 (1x 2/2)
	3.6.1	Tread width, front	b10	mm	-
	3.7.1	Tread width, rear	b11	mm	410 (535)
Dimensions	4.4	Lift height	h3	mm	105
	4.9	Height of tiller handle in drive position min./max.	h14	mm	750/1170
	4.15	Lowered height	h13	mm	82
	4.19	Overall length	l1	mm	1604
	4.20	Length to face of forks	l2	mm	450
	4.21	Overall width	b1/b2	mm	695/620
	4.22	Fork dimensions	s/e/l	mm	55/150/1150
	4.25	Distance between fork-arms	b5	mm	685/560
	4.32	Ground clearance, center of wheelbase	m2	mm	25
	4.34.1	Aisle width for pallets 1000×1200 crossways	Ast	mm	2187
	4.34.2	Aisle width for pallets 800×1200 crossways	Ast	mm	2244
4.35	Turning radius	Wa	mm	1426	
Performance data	5.1	Travel speed, laden/unladen		km/h	4/4.5
	5.2	Lifting speed, laden/unladen		m/s	0.02/0.026
	5.3	Lowering speed, laden/unladen		m/s	0.069/0.055
	5.8	Max. gradeability, laden/unladen		%	5/16
	5.10	Service brake			Electromagnetic
Electric-engine	6.1	Drive motor rating S2 60 min		kW	0.75
	6.2	Lift motor rating at S3 15%		kW	0.5
	6.4	Battery voltage/nominal capacity		V/Ah	12*2/65Ah
	6.5	Battery weight		kg	15*2
Addition data	8.1	Type of drive control			DC
	10.5	Steering design			Mechanical
	10.7	Sound pressure level at the driver's ear		dB(A)	<74

If there are improvements of technical parameters or configurations, no further notice will be given.
The diagram shown may contain non-standard configurations.

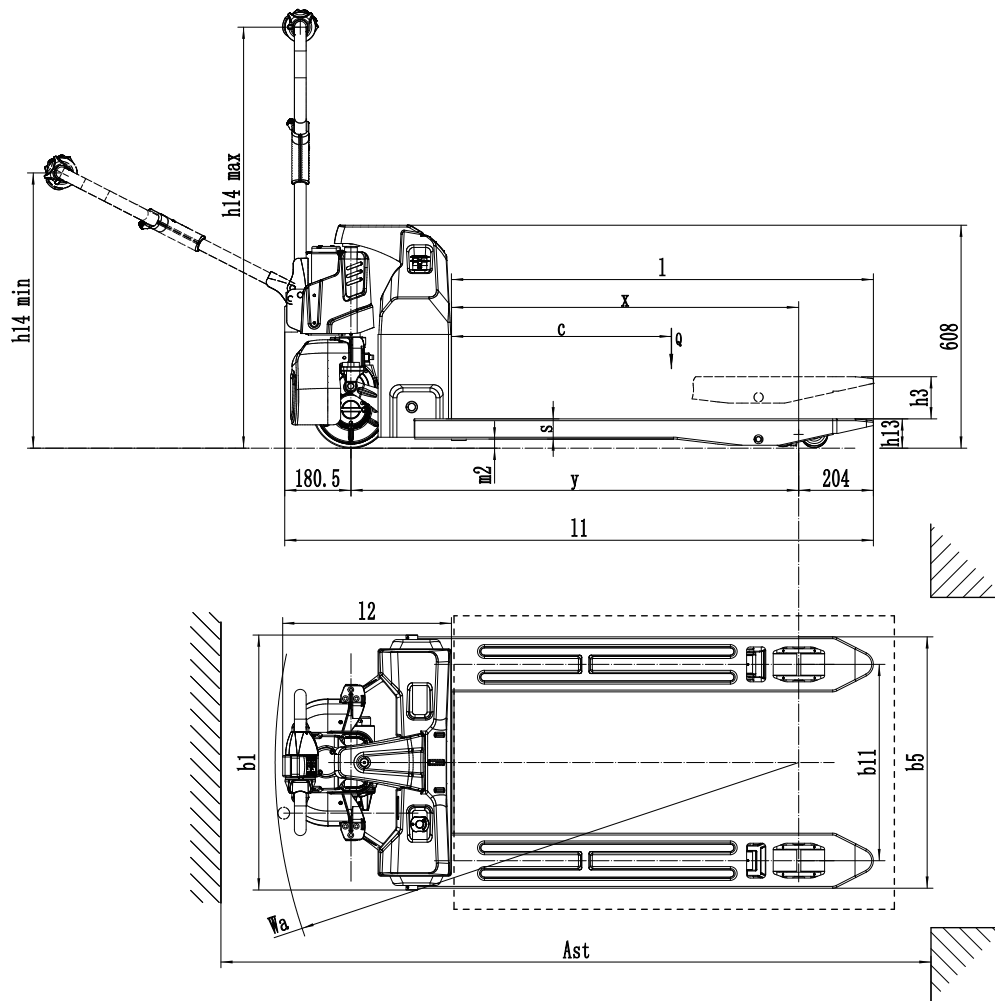

Option:

No.	Optional items	F1
1.2	Fork width	● 1150*560 ○ 560*900/1000/1220/1350/1500 ○ 1150*685 ○ 685**900/1000/1220/1350/1500
1.3	Fork lowered height	● 80
1.6	Drive cover off the ground	● 45mm ○ 65mm (Non-CE)
2.1	Load wheel type	● Double ○ Single
2.2	Load wheel material	● Polyurethane
2.3	Drive wheel material	● Polyurethane
2.7	Battery capacity	● 24V 65Ah
2.8	Charger	● 24V-10A Internal
2.9	Battery indicator	● Without time
3.12	Buzzer	● Yes and not customized
2.16	Handle head type	● Hands handle head
3.3	Castor wheels	● No ○ Yes and not customized
3.16	Vertical handler working	● Yes and not customized
4.8	Drive assembly	● Yes and not customized

Note: ● Standard ○ Optional - Inconformity



F Series - F2

Electric Pallet Truck 1.5T

- A smart and sleek truck for retail usage
- Sleek truck frame and lithium technology
- Upgraded load capacity offering greater productivity
- New tiller head for ergonomics
- Unique Platform F design reducing costs throughout the distribution cycle

LI-ION
TECHNOLOGY

EP EQUIPMENT CO.,LTD
www.ep-equipment.com



F2 - A smart and sleek truck for retail usage

■ Sleek truck frame and lithium technology

F2 is born from the market-proven model EPT12-EZ and carries its strengths on both appearance and lithium power supply. Its sleek truck frame is perfect for handling usage in supermarkets and malls. And the smart Li-ion battery makes F2 always available for retail usage due to opportunity charging and maintenance free.



■ Upgraded load capacity offering greater productivity

F2 comes with 120kg self weight but higher load capacity 1.5 ton than EPT12-EZ, offering greater productivity boost.



■ New tiller head for ergonomics

F2 adopts a new tiller head for an user to operate the truck more easily using the palm of his hand, instead of controlling the knob with thumbs. The pinch force exerted on a control knob during operations can be minimized so that excessive physical stress and strain on the hands are reduced.



Why F Series ?

■ Platform-based design to maximize competitive advantage in the market

F series features the platform F, which simplifies the configuration of the truck and allows buyers to choose from 4 different chassis by application. The product design provides value and creates a flexible product strategy by introducing new equipment that meets various market requirements.



■ Cost-saving operations throughout the distribution cycle

4 units per box as standard wholesale supply reduces overall spending through the entire distribution process. F2 accommodates **176** units in a 40' shipping container compared to 108 units of EPT12-EZ, that can reach as high as **30-40%** of ocean freight charges reduction.

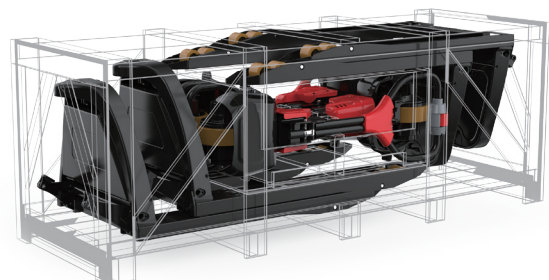

Electric Pallet Truck 1.5T

F2

Distinguishing mark	1.1	Manufacturer			EP
	1.2	Model designation			F2
	1.3	Drive			Electric
	1.4	Operator type			Pedestrian
	1.5	Load capacity	Q	kg	1500
	1.6	Load center distance	c	mm	600
	1.8	Load distance, centre of drive axle to fork	x	mm	950
	1.9	Wheelbase	y	mm	1180
	Service weight	2.1	Service weight		kg
2.2		Axle loading, laden front/rear		kg	480/1140
2.3		Axle loading, unladen front/rear		kg	90/30
Tyres/chassis	3.1	Tyre type			Polyurethane
	3.2.1	Tyre size, front		mm	210x70
	3.3.1	Tyre size, rear		mm	Φ80x60(Φ74x88)
	3.4	Additional wheels (castor wheels)		mm	Φ74x30 optional
	3.5	Wheels, number front/rear (x=drive wheels)		mm	1x 2/4 (1x 2/2)
	3.6.1	Tread width, front	b10	mm	—
	3.7.1	Tread width, rear	b11	mm	535/410
Dimensions	4.4	Lift height	h3	mm	105
	4.9	Height of tiller handle in drive position min./max.	h14	mm	750/1190
	4.15	Lowered height	h13	mm	82
	4.19	Overall length	l1	mm	1550
	4.20	Length to face of forks	l2	mm	400
	4.21	Overall width	b1/b2	mm	695/590
	4.22	Fork dimensions	s/e/l	mm	55/150/1150
	4.25	Distance between fork-arms	b5	mm	685/560
	4.32	Ground clearance, center of wheelbase	m2	mm	25
	4.34.1	Aisle width for pallets 1000×1200 crossways	Ast	mm	2160
4.34.2	Aisle width for pallets 800×1200 crossways	Ast	mm	2025	
4.35	Turning radius	Wa	mm	1360	
Performance data	5.1	Travel speed, laden/unladen		km/h	4/4.5
	5.2	Lifting speed, laden/unladen		m/s	0.017/0.020
	5.3	Lowering speed, laden/unladen		m/s	0.046/0.058
	5.8	Max. gradeability, laden/unladen		%	5/16
	5.10	Service brake			Electromagnetic
Electric-engine	6.1	Drive motor rating S2 60 min		kW	0.75
	6.2	Lift motor rating at S3 15%		kW	0.5
	6.4	Battery voltage/nominal capacity		V/Ah	24/20
	6.5	Battery weight		kg	5
	Addition data	8.1	Type of drive control		
10.5		Steering design			Mechanical
10.7		Sound pressure level at the driver's ear		dB(A)	<74

If there are improvements of technical parameters or configurations, no further notice will be given.
The diagram shown may contain non-standard configurations.

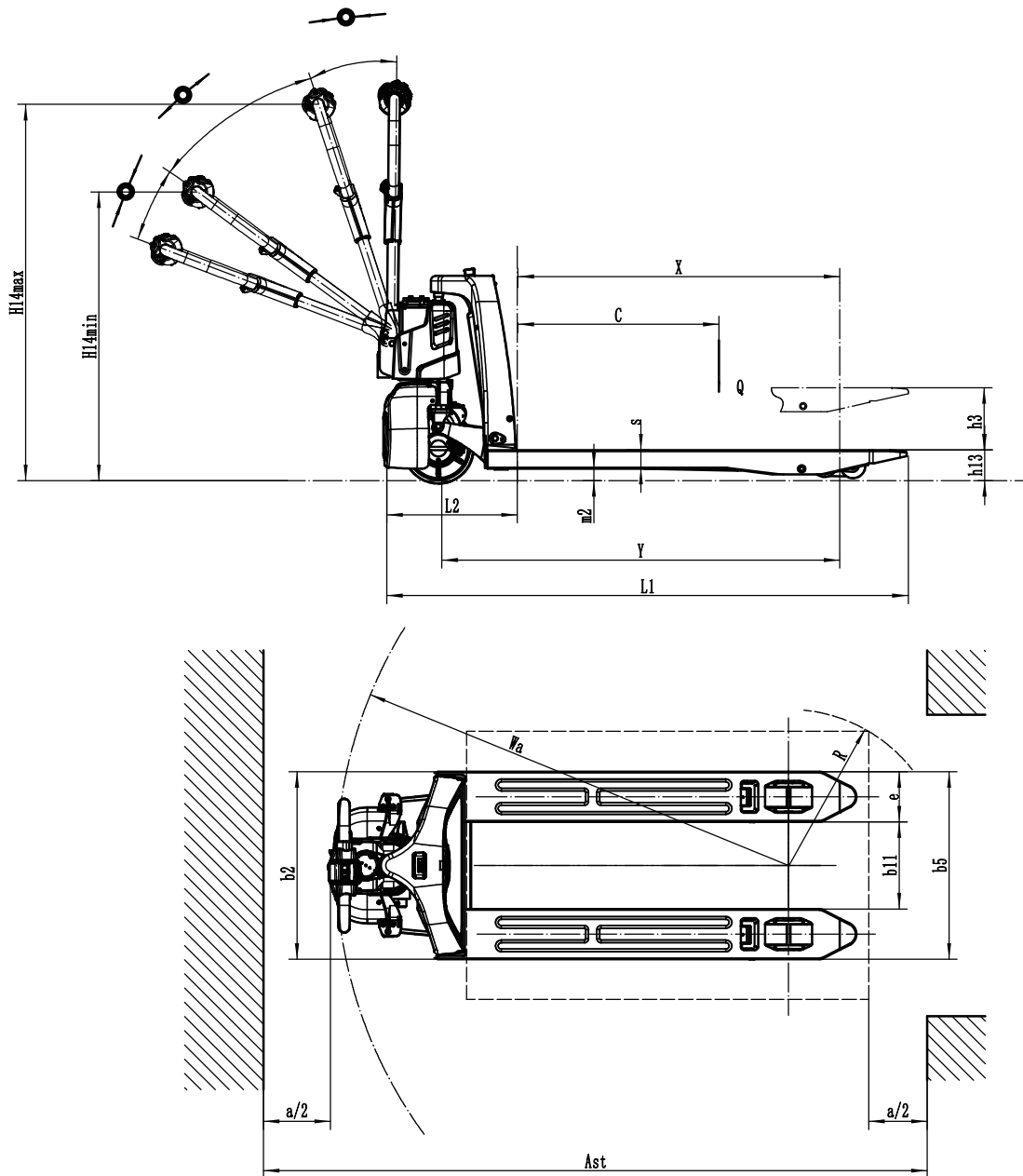

Option:

No.	Optional items	F2
1.1	Fork dimension	●1150*560○800*560○900*560○1000*560○1220*560○1350*560○1500*560 ○800*685○900*685○1000*685○1150*685○1220*685○1350*685○1500*685
1.3	Fork lowered height	●80
1.6	Drive cover off the ground	●55mm
2.1	Load wheel type	●Double○Single
2.2	Load wheel material	●PU
2.3	Drive wheel material	●PU
2.7	Battery capacity	●20AH
2.8	Charger	●24V-5A external○24V-10A external
2.9	Battery indicator	●Without time
2.16	handle head type	●Hands big handle head○Hands small handle head
3.3	Castor wheels	●No○Yes and not customized
3.12	Buzzer	●Yes and not customized
3.16	Turtle speed	●Yes and not customized
4.8	Drive assembly	●Yes and not customized

Note: ●Standard ○Optional - Inconformity



F3

Li-ion Pallet Truck 1.5T

- A tough truck for transportation in logistics centers
- Strong structure and Li-ion heart
- Upgraded tiller head for ergonomics
- Flip cover for battery safety assurance
- Unique Platform F design reducing costs throughout the distribution cycle

LI-ION
TECHNOLOGY

EP EQUIPMENT CO.,LTD
www.ep-equipment.com



F3 - A tough truck for transportation in logistics centers

■ Strong structure and Li-ion heart

F3 continues the advantage of EPL153(1), a simple and strong truck frame and a plug&play Li-ion battery. These deliver tough performance when transporting goods in logistics centers based on different work shift needs.



■ Upgraded tiller head for ergonomics

F3 adopts a new tiller head for an user to operate the truck more easily using the palm of his hand, instead of controlling the knob with thumbs. The pinch force exerted on a control knob during operations can be minimized so that excessive physical stress and strain on the hands are reduced.



■ Flip cover for battery safety assurance

Its flip cover design protects the battery from water ingress, which ensures operation safety.



Why F Series ?

■ Platform-based design to maximize competitive advantage in the market

F series features the platform F, which simplifies the configuration of the truck and allows buyers to choose from 4 different chassis by application. The product design provides value and creates a flexible product strategy by introducing new equipment that meets various market requirements.



■ Cost-saving operations throughout the distribution cycle

4 units per box as standard wholesale supply reduces overall spending through the entire distribution process. F3 accommodates **176** units in a 40' shipping container compared to 108 units of EPL153(1), that can reach as high as **30-40%** of ocean freight charges reduction.

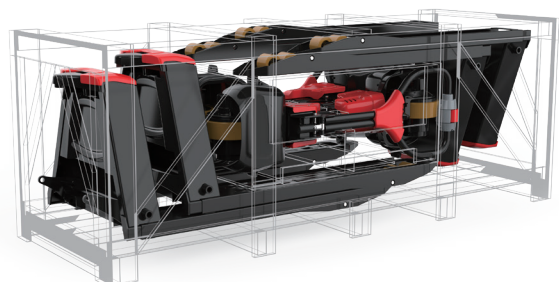

Electric Pallet Truck 1.5T

F3

Distinguishing mark	1.1	Manufacturer			EP
	1.2	Model designation			F3
	1.3	Drive			Electric
	1.4	Operator type			Pedestrian
	1.5	Load capacity	Q	kg	1500
	1.6	Load center distance	c	mm	600
	1.8	Load distance, centre of drive axle to fork	x	mm	950
	1.9	Wheelbase	y	mm	1180
	Service weight	2.1	Service weight		kg
2.2		Axle loading, laden front/rear		kg	480/1140
2.3		Axle loading, unladen front/rear		kg	90/30
Tyres/chassis	3.1	Tyre type			Polyurethane
	3.2.1	Tyre size, front		mm	210x70
	3.3.1	Tyre size, rear		mm	Φ80x60(Φ74x88)
	3.4	Additional wheels (castor wheels)		mm	Φ74x30 optional
	3.5	Wheels, number front/rear (x=drive wheels)		mm	1x 2/4 (1x 2/2)
	3.6.1	Tread width, front	b10	mm	—
	3.7.1	Tread width, rear	b11	mm	535/410
Dimensions	4.4	Lift height	h3	mm	105
	4.9	Height of tiller handle in drive position min./max.	h14	mm	750/1190
	4.15	Lowered height	h13	mm	82
	4.19	Overall length	l1	mm	1550
	4.20	Length to face of forks	l2	mm	400
	4.21	Overall width	b1/b2	mm	695/590
	4.22	Fork dimensions	s/e/l	mm	55/150/1150
	4.25	Distance between fork-arms	b5	mm	685/560
	4.32	Ground clearance, center of wheelbase	m2	mm	25
	4.34.1	Aisle width for pallets 1000×1200 crossways	Ast	mm	2160
	4.34.2	Aisle width for pallets 800×1200 crossways	Ast	mm	2025
4.35	Turning radius	Wa	mm	1360	
Performance data	5.1	Travel speed, laden/unladen		km/h	4/4.5
	5.2	Lifting speed, laden/unladen		m/s	0.017/0.020
	5.3	Lowering speed, laden/unladen		m/s	0.046/0.058
	5.8	Max. gradeability, laden/unladen		%	5/16
	5.10	Service brake			Electromagnetic
Electric-engine	6.1	Drive motor rating S2 60 min		kW	0.75
	6.2	Lift motor rating at S3 15%		kW	0.5
	6.4	Battery voltage/nominal capacity		V/Ah	24/20
	6.5	Battery weight		kg	5
	Addition data	8.1	Type of drive control		
10.5		Steering design			Mechanical
10.7		Sound pressure level at the driver's ear		dB(A)	<74

If there are improvements of technical parameters or configurations, no further notice will be given.
The diagram shown may contain non-standard configurations.

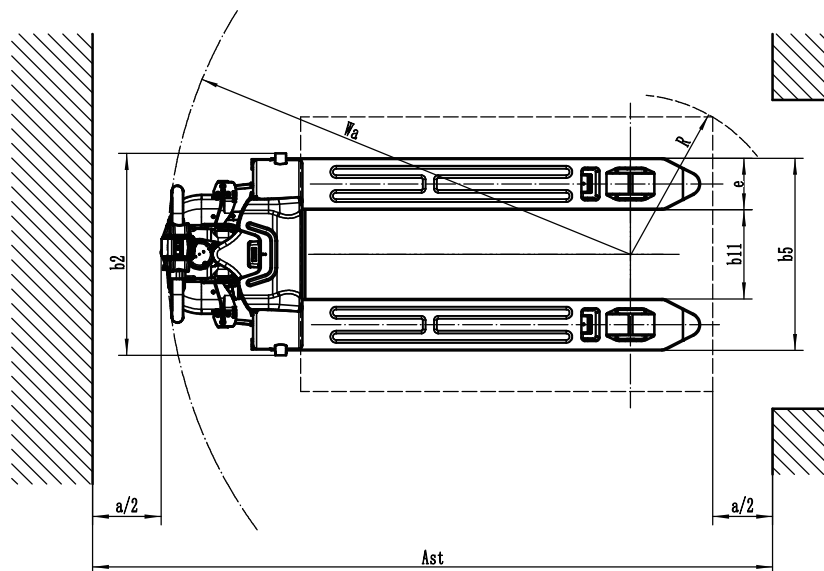
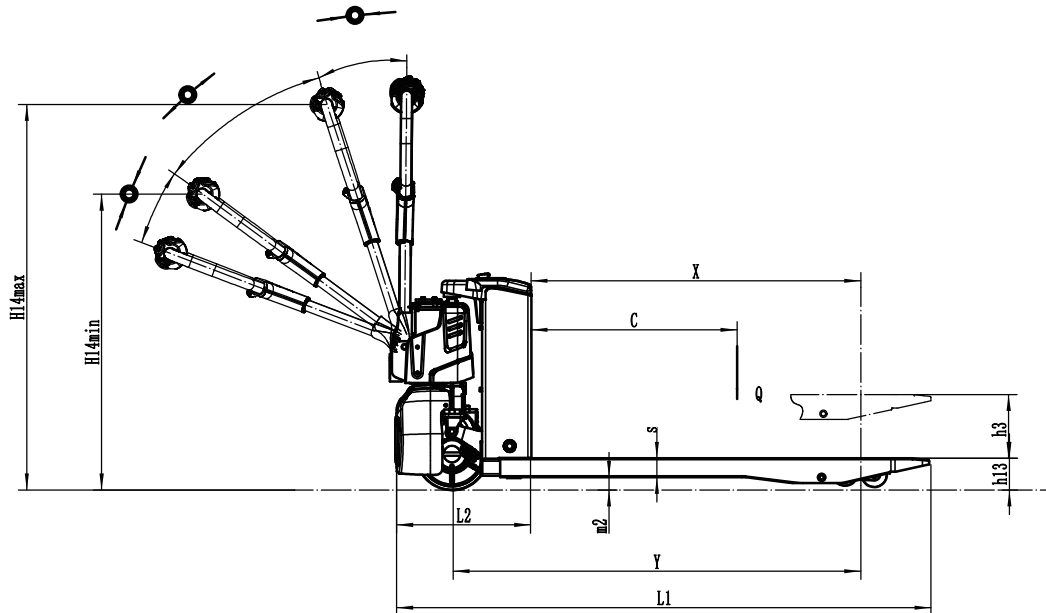

Option:

No.	Optional items	F3
1.1	Fork dimension	●1150*560○800*560○900*560○1000*560○1220*560○1350*560○1500*560 ○800*685○900*685○1000*685○1150*685○1220*685○1350*685○1500*685
1.3	Fork lowered height	●80
1.6	Drive cover off the ground	●55mm
2.1	Load wheel type	●Double○Single
2.2	Load wheel material	●PU
2.3	Drive wheel material	●PU
2.7	Battery capacity	●20AH
2.8	Charger	●24V-5A external○24V-10A external
2.9	Battery indicator	●Without time
2.16	handle head type	●Hands big handle head○Hands small handle head
3.3	Castor wheels	●No○Yes and not customized
3.12	Buzzer	●Yes and not customized
3.16	Turtle speed	●Yes and not customized
4.8	Drive assembly	●Yes and not customized

Note: ●Standard ○ Optional - Inconformity

F4

Transpallet elettrico 1500kg



- Design semplice, realizzato con componenti collaudati nel settore.
- Sforzo dell'operatore ridotto e aumento dell'efficienza
- Dimensione compatta (l2=400mm) e peso ridotto (120kg)
- Fino a 2 batterie al litio da 24V - 20Ah rimovibili
- Disponibile in diverse lunghezze e larghezze delle forche



Costruttore			EP
Modello			F4
Alimentazione			Elettrica
Portata nominale	Q	kg	1500
Baricentro	c	mm	600
Peso del carrello		kg	120
Lunghezza carrello forze escluse	l2	mm	400
Lunghezza telaio	b1/b2	mm	590/695
Dimensioni forche	s/e/l	mm	55/150/1150
Raggio di sterzata	Wa	mm	1360
Pendenza superabile con/senza carico		%	6/16
Tensione batteria/capacità nominale		V/Ah	24/20

F4 - Polivalente per diverse applicazioni

L'F4 offre la massima flessibilità nelle configurazioni per ogni applicazione, dall'uso occasionale a quello intensivo, dai carichi standard a quelli elevati.

standard ai grandi carichi. Dotato di un design a due slot di alimentazione, l'F4 offre l'opzione di due batterie da 24 V/20 Ah per massimizzare i tempi di attività per le applicazioni a tempo pieno. L'impostazione standard a batteria singola viene fornita con un contenitore portatile per tenere tutto facilmente accessibile in viaggio.

Un'altra opzione è rappresentata dalle ruote stabilizzatrici che consentono di gestire grandi carichi riducendo il rischio di cadute e danni su pavimenti irregolari. Entrambe le opzioni possono essere offerte direttamente dalla fabbrica o come retrofit. La sua versatilità rende l'F4 un veicolo tuttfare, perfetto per svolgere diverse mansioni nel modo più economico e vantaggioso.



Battery option



Stablizing wheel option

Perché la Serie F?

- **Design basato sulla piattaforma per massimizzare il vantaggio competitivo sul mercato**

La serie F è caratterizzata dalla piattaforma F, che semplifica la configurazione del carrello e consente agli acquirenti di scegliere tra 4 diversi telai in base all'applicazione. Il design del prodotto fornisce valore e crea una strategia di prodotto flessibile, introducendo nuovi equipaggiamenti che soddisfano le varie esigenze del mercato.



- **Operazioni di risparmio dei costi durante l'intero ciclo di distribuzione**

4 unità per scatola come fornitura standard all'ingrosso riducono la spesa complessiva nell'intero processo di distribuzione. L'F4 può contenere 176 unità in un container da 40' rispetto alle 108 unità dell'EPT12-EZ, con una riduzione delle spese di trasporto marittimo fino al 30-40%.

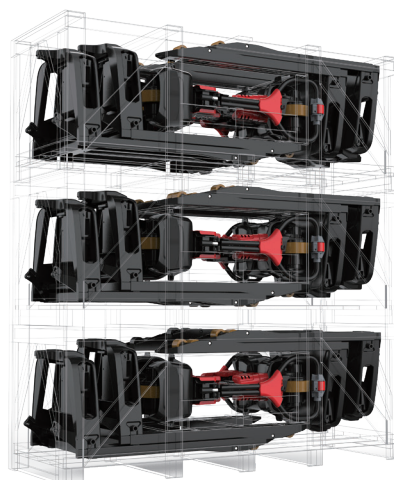

Li-Ion Pallet Truck 1.5T F4

Caratteristiche	1.1	Costruttore			EP
	1.2	Modello			F4
	1.3	Alimentazione			Electric
	1.4	Guida			Pedestrian
	1.5	Portata nominale	Q	kg	1500
	1.6	Baricentro	c	mm	600
	1.8	Distanza schiena forche/asse ant. (forca sollevata/abbassata)	x	mm	950
	1.9	Interasse Ruote	y	mm	1180
	Peso	2.1	Peso del carrello		kg
2.2		Pressione, con carico, su ruota trazione/ pivottante/ rulli forche		kg	480/1140
2.3		Pressione, a vuoto, su ruota trazione/ pivottante/ rulli forche		kg	90/30
Pneumatici / Telaio	3.1	Ruota trazione/pivottante/rulli forche			Polyurethane
	3.2.1	Dimensione del pneumatico, anteriore		mm	210x70
	3.3.1	Dimensione del pneumatico, posteriore		mm	Φ80x60(Φ74x88)
	3.4	Ruote aggiuntive (ruote piroettanti)		mm	Φ74x30 optional
	3.5	Ruote, numero anteriore/posteriore (x=ruote comandate)		mm	1x 2/4 (1x 2/2)
	3.6.1	Carreggiata anteriore	b10	mm	-
	3.7.1	Carreggiata posteriore	b11	mm	535/410
Dimensioni	4.4	Sollevamento forche	h3	mm	105
	4.9	Altezza timone in posizione di guida min./max.	h14	mm	750/1190
	4.15	Altezza, forche abbassate	h13	mm	82
	4.19	Lunghezza totale	l1	mm	1550
	4.20	Lunghezza carrello forche escluse	l2	mm	400
	4.21	Larghezza telaio	b1/b2	mm	695/590
	4.22	Dimensioni forche	s/e/l	mm	55/150/1150
	4.25	Scartamento esterno forche	b5	mm	685/560
	4.32	Luce da terra, centro dell'interasse	m2	mm	25
	4.34.1	Corridoio di stivaggio per pallet 1000x1200 trasversale	Ast	mm	2160
	4.34.2	Corridoio di stivaggio per pallet 800x1200 nel senso della lunghezza	Ast	mm	2025
	4.35	Raggio di sterzata	Wa	mm	1360
	Prestazioni	5.1	Velocità di trazione, con/senza carico		km/h
5.2		Velocità di sollevamento, con/senza carico		m/s	0.017/0.020
5.3		Velocità di discesa, con/senza carico		m/s	0.046/0.058
5.8		Pendenza superabile con/senza carico		%	5/16
5.10		Freno di servizio			Electromagnetic
Motore elettrico	6.1	Potenza motore di trazione S2 60 min		kW	0.75
	6.2	Potenza del motore di sollevamento a S3 15%		kW	0.5
	6.4	Tensione batteria/capacità nominale		V/Ah	24/20
	6.5	Peso della batteria		kg	5
Altri	8.1	Tipo di controllo motore			DC
	10.5	Progettazione dello sterzo			Mechanical
	10.7	Livello di pressione sonora all'orecchio del conducente		dB(A)	<74

If there are improvements of technical parameters or configurations, no further notice will be given.
The diagram shown may contain non-standard configurations.

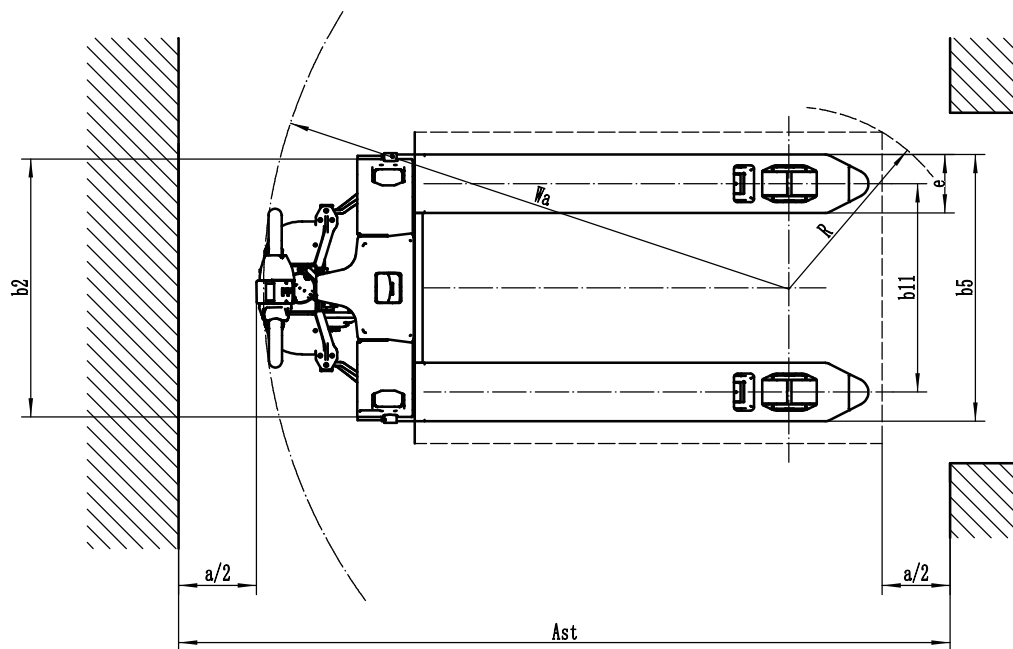
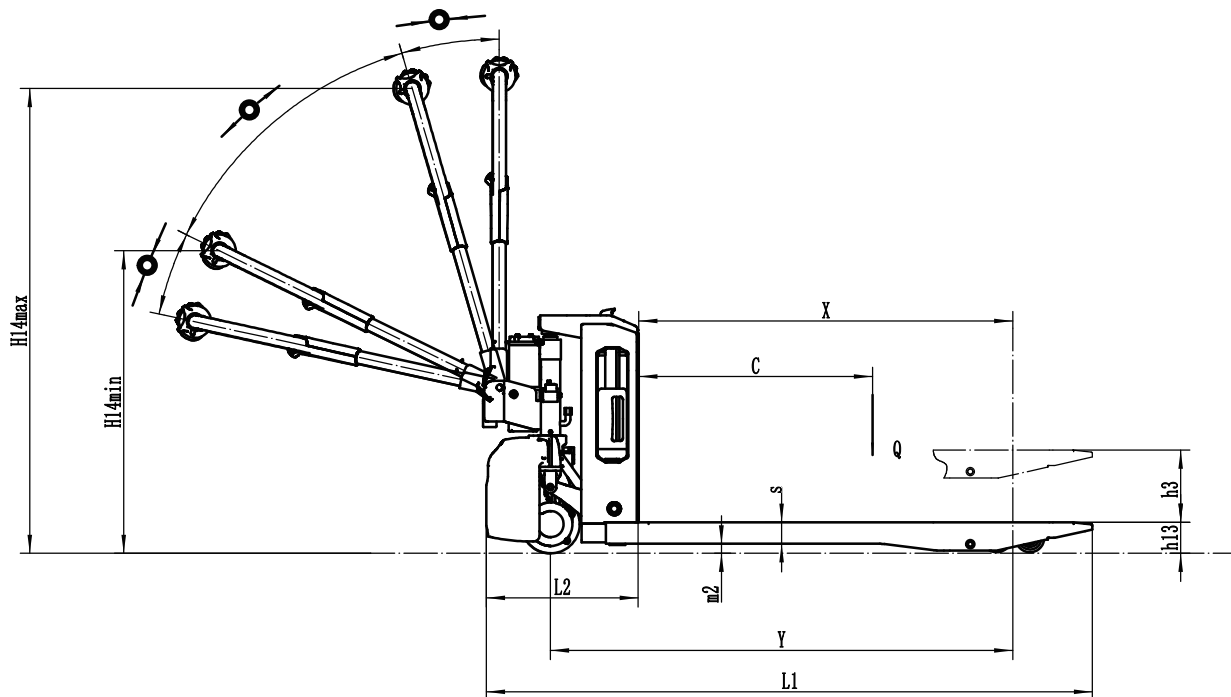

Option:

No.	Elementi opzionali	F4
1.1	Dimensione forche	●1150*560○900*560○1000*560○1220*560○1350*560○1500*560 ○900*685○1000*68○1150*685○1220*685○1350*685○1500*685
1.3	Altezza forca abbassata	●80
1.6	Altezza fascia parapiedi	●55mm
2.1	Tipo di ruota di carico	●Double○Single
2.2	Materiale ruota di caricp	●PU
2.3	Materiale ruote motrici	●PU
2.7	Capacità della batteria	●20AH×1, scatola di immagazzinaggio portatile x1 ○20AH×2○20AH×3○20AH×4
2.8	Caricabatterie	●24V-4A esterno○24V-10A esterno
2.9	Indicatore della batteria	●Senza tempo
2.16	Tipo timoniera	●Mani testa maniglia piccola
3.3	Ruote piroettanti	●No○Si e non personalizzato
3.12	Hummer	●Si e non personalizzato
3.16	Movimentatore verticale funzionante	●Si e non personalizzato
4.8	Gruppo trazione	●Si e non personalizzato
Nota: ●Standard ○ Opzionale - Non conformità		